

## Strawbale house Schier

### Short description

**Planning:** Dipl. Ing. Architect Dirk Scharmer, Lueneburg  
**Building place:** one-family house in the "Wendland" Niedersachsen  
**Design:** 1,5-story strawbale house with clay-plastered post and beam structure  
**Size:** approx. 170m<sup>2</sup> effective area  
**Carrying out:** different companies, wallraising and clay-plastering partial in personal investment and workshops  
**Time:** May 2003 to February 2004  
**Expenses:** approx. 1.250 EUR/m<sup>2</sup> effective area

### Short specification

**Foundation:** Concrete strip foundations, base slab without re bars;  
**Floor:** Cellulose-insulation, wooden floor and tiles;  
**Walls:** posts were placed in intervals of 1,5 - 3,5m, level board bars in intervals of 1 m, strawbales were placed between these bars, inside clay plaster 5cm, on the exterior walls clay plaster 3cm + specific lime plaster on the outer clay plaster, partial wood sheeting  
**Roof construction:** purlin roof dammed with strawbales, rafter as hollow tubular section carriers (Inside flax insulation) made according to the height of the strawbales (d=46cm); clay; roofing tiles;  
**Inside expansion:** Inner surfaces of 10cm strong straw-clay- prefabricated elements (Co. Karphosit). Surfaced with clay plaster d=1,5 cm, air density via crack avoidance and adhesive of the connections

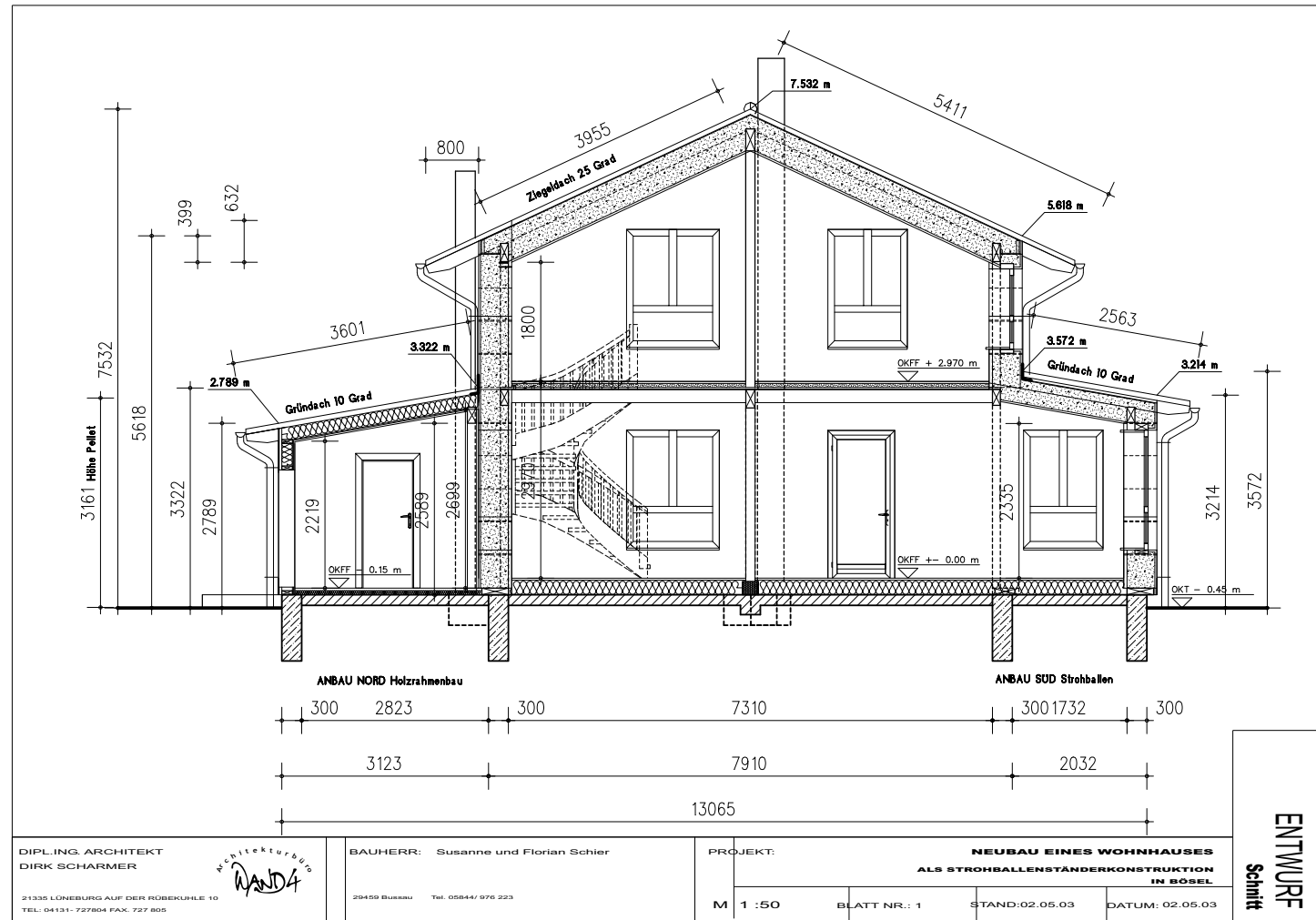

design



construction process



complete straw - walls



clay- plastered



lime-plastered wall

ENTWURF  
 Schmitz